

**SCHOOL DISTRICT OF MANAWA  
BUILDINGS & GROUNDS COMMITTEE MEETING AGENDA**

**Join with Google Meet**

[meet.google.com/pes-qmbj-dst](https://meet.google.com/pes-qmbj-dst)

**Join by phone**

(US) +1 337-445-0358 PIN: 935 878 414#

**Date: April 12, 2022**

**Time: 4:30 p.m.**

**Hybrid Meeting Format (In-person Meeting for Board of Education at MES Board Room, 800 Beech Street & Virtual Components)**

**Board Committee Members: R. Johnson (C), Griffin, Hollman**

**In Attendance:**

**Timer:** \_\_\_\_\_ **Recorder:** \_\_\_\_\_

1. Discuss Plans to Upgrade Lighting in West MS/HS Parking Lot - Matt McGregor; Hoffman (Northland Electric) (Information / Action)
2. Discuss Technology Education (Woods & Metals) Duct Detector False Alarm Solutions - Matt McGregor; Hoffman (Information / Action)
  - a. Martin Systems Option 1 - cost for reprogramming and removal of the 2 duct smokes is \$400.
  - b. Martin Systems Option 2 - have the heats shutdown the AHU units will be \$850 which includes the 2 additional relays and removal of the duct detectors.
  - c. Both Option 1 or 2 will require having the mechanical contractor patch the holes in the duct work once Martin Systems removes the duct smokes.
  - d. Mr. McGregor needs to ensure that those units only supply the 1 space as the code states.
  - e. Other
3. Consider Scheduling Reseeding of New Green Spaces (Information / Action)
  - a. Casey Landscaping Cost = \$2,200 to thatch, fertilize, and reseed the green space at the current vacant lot.
  - b. Preferred time is fall due to adequate precipitation; could be done spring/summer if ample watering can be guaranteed.
  - c. Do not use weed killer prior to, or until at least one year after the seed is planted and takes root.
  - d. There are referendum dollars available to address this need.
4. Discuss Care and Maintenance of the Upper Field & Related Structures (Information / Action)

5. Approve Quote for Fisher Tracks, Inc. Rubberized Long Jump as Presented (Information / Action)
6. Approve Quote from Spiegelberg Implement, Inc. for Second Long Jump as Presented (Information / Action)
7. Update on Solar Project (Information)
8. Continue to Brainstorm, Prioritize, and Endorse 2022-23 Fiscal Year Projects as Presented (Information / Action)
9. Update on Maintenance (Information)
  - a. Gym (both) Floor Refinishing - Week of July 11
  - b. Generator Annual Maintenance Contracts - Wolter
  - c. Flushing Irrigation System & Starting Up Well Pump
  - d. MES Lighting Proposal
  - e. MES Vinyl Tile
  - f. MS/HS Library
  - g. Other
10. Review of Monthly Buildings & Grounds Budget (Information)
11. Buildings & Grounds Committee Planning Guide (Information)
12. Set Next Meeting Date: \_\_\_\_\_
13. Next Meeting Items:
  - a. Finalize Review of Key Performance Indicators (Information / Action)
  - b. District Safety Plan, Reunification Plan, and Associated Projects
  - c. Long-term Maintenance Plan - Pfefferle as Presented [Operation Efficiencies] (Information / Action)
  - d. Custodial/Maintenance Plan - Pfefferle as Presented (Information / Action)
  - e. School Forest New Management Plan (Information / Action)
  - f.
  - g.
14. Adjourn



3/28/2022

Hoffman Planning, Design & Construction, Inc.  
P.O. Box 8034  
Appleton, WI 54912

Attn: Matt McGregor  
Re: Manawa School Site Lighting

Dear Matt,

Northland Electrical Services is pleased to provide Hoffman with the following quote for the electrical work associated with site lighting at the Manawa School. Included within our price is labor, materials and equipment to complete as listed in the scope below.

**Option 1: Add (3) additional heads on existing poles \$4,010.00**

- Purchase and install (3) new PRV-C25-D-UNV-T4-SA-BZ-MS/DIM-L40W Heads
- Purchase and install mounting hardware for 3<sup>rd</sup> head
- Lift rental included
- New poles not needed for this install
- Tap off existing power for new fixtures

**Option 2: Add (5) wall packs on side of building \$8,025.00**

- Purchase and install (5) DSXW2 LED 30C 700 40K TFTM 277 SF DDBXD Wall packs
- Install conduit and wire
- New lighting controls if needed is not included at this time
- Lift rental included
- Coordination with school for access to room

**NOTE:**

- No off hours included at this time
- Some material delays expected due to current economy

If you have any questions, please feel free to call me at (920)531-1197.

Sincerely,

**Shane Schabo**

Shane Schabo

Northland Electrical Services LLC

# D-Series Size 2 LED Wall Luminaire



d<sup>series</sup>



Buy American

Catalog Number
Notes
Type

Hit the Tab key or mouse over the page to see all interactive elements.

## A+ Capable Luminaire

This item is an A+ capable luminaire, which has been designed and tested to provide consistent color appearance and system-level interoperability.

- All configurations of this luminaire meet the Acuity Brands' specification for chromatic consistency
- This luminaire is A+ Certified when ordered with DTL<sup>®</sup> controls marked by a **shaded background**. DTL DLL equipped luminaires meet the A+ specification for luminaire to photocontrol interoperability<sup>1</sup>
- This luminaire is part of an A+ Certified solution for ROAM<sup>®</sup> or XPoint<sup>™</sup> Wireless control networks, providing out-of-the-box control compatibility with simple commissioning, when ordered with drivers and control options marked by a **shaded background**<sup>1</sup>

To learn more about A+, visit [www.acuitybrands.com/aplus](http://www.acuitybrands.com/aplus).

1. See ordering tree for details.
2. A+ Certified Solutions for ROAM require the order of one ROAM node per luminaire. Sold Separately: [Link to Roam](#); [Link to DTL DLL](#)

## Specifications Luminaire

**Width:** 18-1/2" (47.0 cm) **Weight:** 21 lbs (9.5 kg)  
**Depth:** 10" (25.4 cm)  
**Height:** 7-5/8" (19.4 cm)

## Back Box (BBW)

**Width:** 5-1/2" (14.0 cm) **BBW Weight:** 1 lbs (0.5 kg)  
**Depth:** 1-1/2" (3.8 cm)  
**Height:** 4" (10.2 cm)

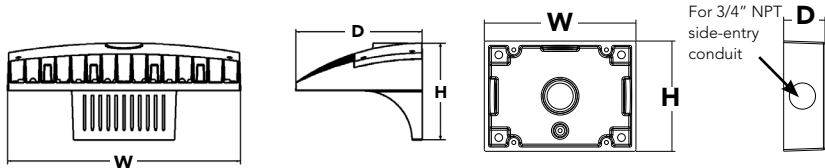

A+ Capable options indicated by this color background.

## Ordering Information

**EXAMPLE: DSXW2 LED 30C 700 40K T3M MVOLT DDBTXD**

DSXW2 LED		Drive Current		Color temperature		Distribution		Voltage		Mounting		Control Options	
Series	LEDs												
DSXW2 LED	20C	20 LEDs (two engines)	350	350 mA	30K	3000 K	T2S	Type II Short	MVOLT <sup>3</sup>	<b>Shipped included</b> (blank) Surface mounting bracket  <b>Shipped separately<sup>6</sup></b> BBW Surface-mounted back box (for conduit entry)	<b>Shipped installed</b>		
	30C	30 LEDs (three engines)	530	530 mA	40K	4000 K	T2M	Type II Medium	120 <sup>4</sup>		PE	Photoelectric cell, button type <sup>7</sup>	
			700	700 mA	50K	5000 K	T3S	Type III Short	208 <sup>4</sup>		PER	NEMA twist-lock receptacle only (control ordered separately) <sup>8</sup>	
			1000	1000 mA <sup>1</sup> (1 A)	AMBPC	Amber phosphor converted <sup>2</sup>	T3M	Type III Medium	240 <sup>4</sup>		PER5	Five-wire receptacle only (control ordered separately) <sup>8,9</sup>	
							T4M	Type IV Medium	277 <sup>4</sup>		PER7	Seven-wire receptacle only (control ordered separately) <sup>8,9</sup>	
							TFTM	Forward Throw Medium	347 <sup>4,5</sup>		DMG	0-10v dimming wires pulled outside fixture (for use with an external control, ordered separately)	
									480 <sup>4,5</sup>		PIR	180° motion/ambient light sensor, <15' mtg ht <sup>10,11</sup>	
											PIRH	180° motion/ambient light sensor, 15-30' mtg ht <sup>10,11</sup>	
											PIR1FC3V	Motion/ambient sensor, 8-15' mounting height, ambient sensor enabled at 1fc <sup>11,12</sup>	
											PIRH1FC3V	Motion/ambient sensor, 15-30' mounting height, ambient sensor enabled at 1fc <sup>11,12</sup>	

select color most that would blend with the wall

Other Options		Finish (required)							
<b>Shipped installed</b>		<b>Shipped separately<sup>13</sup></b>		DDBXD	Dark bronze	DSSXD	Sandstone	DWHGXD	Textured white
SF	Single fuse (120, 277, 347V) <sup>3</sup>	BSW	Bird-deterrent spikes	DBLXD	Black	DBBTXD	Textured dark bronze	DSSTXD	Textured sandstone
DF	Double fuse (208, 240, 480V) <sup>3</sup>	VG	Vandal guard	DNAXD	Natural aluminum	DBLBXD	Textured black		
HS	House-side shield <sup>4</sup>			DWHXD	White	DNATXD	Textured natural aluminum		
SPD	Separate surge protection <sup>13</sup>								



One Lithonia Way • Conyers, Georgia 30012 • Phone: 1-800-705-SERV (7378) • [www.lithonia.com](http://www.lithonia.com)  
 © 2012-2021 Acuity Brands Lighting, Inc. All rights reserved.

DSXW2-LED  
 Rev. 04/19/21  
 Page 1 of 4

## Ordering Information

### Accessories

Ordered and shipped separately.

DLL127F 1.5 JU	Photozell - SSL twist-lock (120-277V) <sup>14</sup>
DLL347F 1.5 CUL JU	Photozell - SSL twist-lock (347V) <sup>14</sup>
DLL480F 1.5 CUL JU	Photozell - SSL twist-lock (480V) <sup>14</sup>
DSHORT SBK U	Shorting cap (Included when ordering PER, PERS or PER7) <sup>14</sup>
DSXWHS U	House-side shield (one per light engine)
DSXWBSW U	Bird-deterrent spikes
DSXW2VG U	Vandal guard accessory
DSXW2BBW	Back box accessory
DBBXD U	(specify finish)

For more control options, visit [DTL](#) and [ROAM](#) online.

### NOTES

- 1000mA is not available with AMBPC.
- AMBPC is not available with 1000mA.
- MVOLT driver operates on any line voltage from 120-277V (50/60 Hz).
- Single fuse (SF) requires 120, 277 or 347 voltage option. Double fuse (DF) requires 208, 240 or 480 voltage option.
- Available with 30 LED/700mA options only (DSXW2 LED 30C 700). DMG option not available.
- Also available as a separate accessory; see Accessories information.
- Photocontrol (PE) requires 120, 208, 240, 277 or 347 voltage option. Not available with motion/ambient light sensors (PIR or PIRH).
- Photozell ordered and shipped as a separate line item from Acuity Brands Controls. See accessories. Shorting Cap included.
- If ROAM® node required, it must be ordered and shipped as a separate line item from Acuity Brands Controls. Shorting Cap included.
- Reference Motion Sensor table on page 3.
- Reference PER Table on page 3 for functionality.
- PIR and PIR1FC3V specify the [SensorSwitch SBGR-10-ODP](#) control; PIRH and PIRH1FC3V specify the [SensorSwitch SBGR-6-ODP](#) control; see [Motion Sensor Guide](#) for details. Dimming driver standard. Not available with PER5 or PER7. Separate on/off required.
- See the electrical section on page 2 for more details.
- Requires luminaire to be specified with PER option. Ordered and shipped as a separate line item. See PER Table.

## Performance Data

### Lumen Output

Lumen values are from photometric tests performed in accordance with IESNA LM-79-08. Data is considered to be representative of the configurations shown, within the tolerances allowed by Lighting Facts. Contact factory for performance data on any configurations not shown here.

LEDs	Drive Current (mA)	System Watts	Dist. Type	30K					40K					50K				
				Lumens	B	U	G	LPW	Lumens	B	U	G	LPW	Lumens	B	U	G	LPW
20C (20 LEDs)	350 mA	25W	T2S	2,783	1	0	1	111	2,989	1	0	1	120	3,008	1	0	1	120
			T2M	2,709	1	0	1	108	2,908	1	0	1	116	2,926	1	0	1	117
			T3S	2,748	1	0	1	110	2,951	1	0	1	118	2,969	1	0	1	119
			T3M	2,793	1	0	1	112	2,999	1	0	1	120	3,018	1	0	1	121
			T4M	2,756	1	0	1	110	2,959	1	0	1	118	2,977	1	0	1	119
			TFTM	2,753	1	0	1	110	2,956	1	0	1	118	2,975	1	0	1	119
	530 mA	36W	T2S	4,030	1	0	1	112	4,327	1	0	1	120	4,354	1	0	1	121
			T2M	3,920	1	0	1	109	4,210	1	0	1	117	4,236	1	0	1	118
			T3S	3,978	1	0	1	111	4,272	1	0	1	119	4,299	1	0	1	119
			T3M	4,044	1	0	2	112	4,343	1	0	2	121	4,370	1	0	2	121
			T4M	3,990	1	0	1	111	4,284	1	0	1	119	4,310	1	0	1	120
			TFTM	3,987	1	0	1	111	4,281	1	0	1	119	4,308	1	0	1	120
	700 mA	47W	T2S	5,130	1	0	1	109	5,509	1	0	1	117	5,544	1	0	1	118
			T2M	4,991	1	0	2	106	5,360	1	0	2	114	5,393	1	0	2	115
			T3S	5,066	1	0	1	108	5,440	1	0	1	116	5,474	1	0	1	116
			T3M	5,148	1	0	2	110	5,529	1	0	2	118	5,563	1	0	2	118
			T4M	5,080	1	0	2	108	5,455	1	0	2	116	5,488	1	0	2	117
			TFTM	5,075	1	0	2	108	5,450	1	0	2	116	5,484	1	0	2	117
	1000 mA	73W	T2S	7,147	2	0	2	98	7,675	2	0	2	105	7,723	1	0	1	104
			T2M	6,954	2	0	2	95	7,467	2	0	2	102	7,514	2	0	2	103
			T3S	7,057	1	0	2	97	7,579	1	0	2	104	7,627	1	0	2	104
			T3M	7,172	2	0	3	98	7,702	2	0	3	106	7,751	2	0	3	106
			T4M	7,076	1	0	2	97	7,599	1	0	2	104	7,646	1	0	2	105
			TFTM	7,071	1	0	2	97	7,594	1	0	2	104	7,641	1	0	2	105
30C (30 LEDs)	350 mA	36W	T2S	4,160	1	0	1	116	4,467	1	0	1	124	4,494	1	0	1	125
			T2M	4,048	1	0	1	112	4,346	1	0	2	121	4,373	1	0	2	121
			T3S	4,108	1	0	1	114	4,411	1	0	1	123	4,438	1	0	1	123
			T3M	4,174	1	0	2	116	4,483	1	0	2	125	4,510	1	0	2	125
			T4M	4,119	1	0	1	114	4,423	1	0	2	123	4,450	1	0	2	124
			TFTM	4,115	1	0	1	114	4,419	1	0	1	123	4,446	1	0	1	124
	530 mA	54W	T2S	6,001	1	0	1	111	6,444	1	0	1	119	6,484	1	0	1	120
			T2M	5,838	1	0	2	108	6,270	2	0	2	116	6,308	2	0	2	117
			T3S	5,926	1	0	2	110	6,364	1	0	2	118	6,403	1	0	2	119
			T3M	6,023	1	0	2	112	6,467	1	0	2	120	6,507	1	0	2	121
			T4M	5,942	1	0	2	110	6,380	1	0	2	118	6,420	1	0	2	119
			TFTM	5,937	1	0	2	110	6,376	1	0	2	118	6,415	1	0	2	119
	700 mA	71W	T2S	7,403	2	0	2	104	8,170	2	0	2	115	8,221	2	0	2	116
			T2M	7,609	2	0	2	107	7,949	2	0	2	112	7,998	2	0	2	113
			T3S	7,513	1	0	2	106	8,068	1	0	2	114	8,118	1	0	2	114
			T3M	7,635	2	0	3	108	8,199	2	0	3	115	8,250	2	0	3	116
			T4M	7,534	1	0	2	106	8,089	1	0	2	114	8,140	1	0	2	115
			TFTM	7,527	1	0	2	106	8,082	2	0	2	114	8,134	2	0	2	115
	1000 mA	109W	T2S	10,468	2	0	2	96	11,241	2	0	2	103	11,311	2	0	2	104
			T2M	10,184	2	0	3	93	10,936	2	0	3	100	11,005	2	0	3	101
			T3S	10,335	2	0	2	95	11,099	2	0	2	102	11,169	2	0	2	102
			T3M	10,505	2	0	3	96	11,280	2	0	3	103	11,351	2	0	3	104
			T4M	10,365	2	0	2	95	11,129	2	0	2	102	11,198	2	0	2	103
			TFTM	10,356	2	0	2	95	11,121	2	0	3	102	11,190	2	0	3	103

### Note:

Available with phosphor-converted amber LED's (nomenclature AMBPC). These LED's produce light with 97+% >530 nm. Output can be calculated by applying a 0.7 factor to 4000 K lumen values and photometric files.



## Performance Data

### Lumen Ambient Temperature (LAT) Multipliers

Use these factors to determine relative lumen output for average ambient temperatures from 0-40°C (32-104°F).

Ambient		Lumen Multiplier
0°C	32°F	1.02
10°C	50°F	1.01
20°C	68°F	1.00
<b>25°C</b>	<b>77°F</b>	<b>1.00</b>
30°C	86°F	1.00
40°C	104°F	0.98

### Electrical Load

LEDs	Drive Current (mA)	System Watts	Current (A)					
			120V	208V	240V	277V	347V	480V
20C	350	25 W	0.23	0.13	0.12	0.10	-	-
	530	36 W	0.33	0.19	0.17	0.14	-	-
	700	47 W	0.44	0.25	0.22	0.19	-	-
	1000	74 W	0.68	0.39	0.34	0.29	-	-
30C	350	36 W	0.33	0.19	0.17	0.14	-	-
	530	54 W	0.50	0.29	0.25	0.22	-	-
	700	71 W	0.66	0.38	0.33	0.28	0.23	0.16
	1000	109 W	1.01	0.58	0.50	0.44	-	-

### Projected LED Lumen Maintenance

Data references the extrapolated performance projections for the **DSXW2 LED 30C 1000** platform in a **25°C ambient**, based on 10,000 hours of LED testing (tested per IESNA LM-80-08 and projected per IESNA TM-21-11).

To calculate LLF, use the lumen maintenance factor that corresponds to the desired number of operating hours below. For other lumen maintenance values, contact factory.

Operating Hours	0	25,000	50,000	100,000
Lumen Maintenance Factor	1.0	0.95	0.92	0.87

### Motion Sensor Default Settings

Option	Dimmed State	High Level (when triggered)	Photocell Operation	Dwell Time	Ramp-up Time	Ramp-down Time
PIR or PIRH	3V (37%) Output	10V (100%) Output	Enabled @ 5FC	5 min	3 sec	5 min
*PIR1FC3V or PIRH1FC3V	3V (37%) Output	10V (100%) Output	Enabled @ 1FC	5 min	3 sec	5 min

\*For use when motion sensor is used as dusk to dawn control

### PER Table

Control	PER (3 wire)	PER5 (5 wire)		PER7 (7 wire)		
			Wire 4/Wire5		Wire 4/Wire5	Wire 6/Wire7
Photocontrol Only (On/Off)	✓	⚠	Wired to dimming leads on driver	⚠	Wired to dimming leads on driver	Wires Capped inside fixture
ROAM	⊘	✓	Wired to dimming leads on driver	⚠	Wired to dimming leads on driver	Wires Capped inside fixture
ROAM with Motion	⊘	⚠	Wired to dimming leads on driver	⚠	Wired to dimming leads on driver	Wires Capped inside fixture
Futureproof*	⊘	⚠	Wired to dimming leads on driver	✓	Wired to dimming leads on driver	Wires Capped inside fixture
Futureproof* with Motion	⊘	⚠	Wired to dimming leads on driver	✓	Wired to dimming leads on driver	Wires Capped inside fixture

- ✓ Recommended
- ⊘ Will not work
- ⚠ Alternate

\*Futureproof means: Ability to change controls in the future.

Isofootcandle plots for the DSXW2 LED 30C 1000 40K. Distances are in units of mounting height (25').

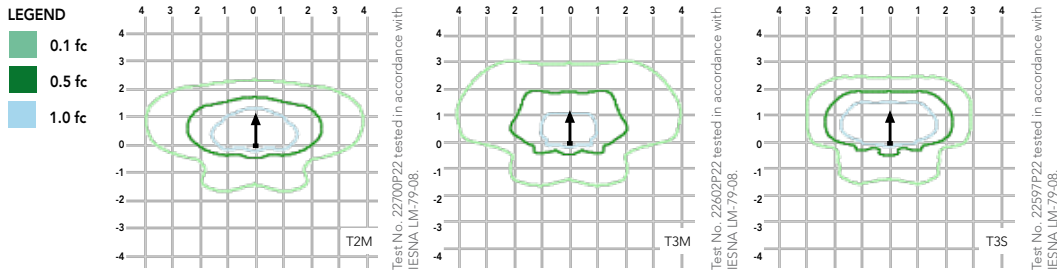

Distribution overlay comparison to 400W metal halide.

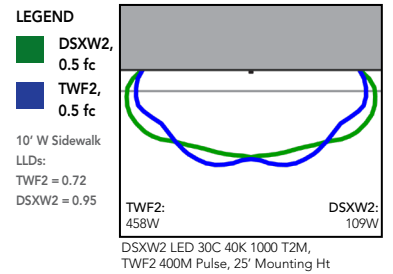

## FEATURES & SPECIFICATIONS

### INTENDED USE

The energy savings, long life and easy-to-install design of the D-Series Wall Size 2 make it the smart choice for building-mounted doorway and pathway illumination for nearly any facility.

### CONSTRUCTION

Two-piece die-cast aluminum housing has integral heat sink fins to optimize thermal management through conductive and convective cooling. Modular design allows for ease of maintenance. The LED driver is mounted to the door to thermally isolate it from the light engines for low operating temperature and long life. Housing is completely sealed against moisture and environmental contaminants (IP65).

### FINISH

Exterior parts are protected by a zinc-infused Super Durable TGIC thermoset powder coat finish that provides superior resistance to corrosion and weathering. A tightly controlled multi-stage process ensures a minimum 3 mils thickness for a finish that can withstand extreme climate changes without cracking or peeling. Available in textured and non-textured finishes.

### OPTICS

Precision-molded proprietary acrylic lenses provide multiple photometric distributions tailored specifically to building mounted applications. Light engines are available in 3000 K (70 min. CRI), 4000 K (70 min. CRI) or 5000 K (70 min. CRI) configurations.

### ELECTRICAL

Light engine(s) consist of 10 high-efficacy LEDs mounted to a metal-core circuit board to maximize heat dissipation and promote long life (L87/100,000 hrs at 25°C). Class 1 electronic drivers have a power factor >90%, THD <20%, and a minimum 2.5KV surge rating. When ordering the SPD option, a separate surge protection device is installed within the luminaire which meets a minimum Category C Low (per ANSI/IEEE C62.41.2).

### INSTALLATION

Included universal mounting bracket attaches securely to any 4" round or square outlet box for quick and easy installation. Luminaire has a slotted gasket wireway and attaches to the mounting bracket via corrosion-resistant screws.

### LISTINGS

CSA certified to U.S. and Canadian standards. Rated for -40°C minimum ambient.

DesignLights Consortium® (DLC) qualified product. Not all versions of this product may be DLC qualified. Please check the DLC Qualified Products List at [www.designlights.org](http://www.designlights.org) to confirm which versions are qualified.

### BUY AMERICAN

This product is assembled in the USA and meets the Buy America(n) government procurement requirements under FAR, DFARS and DOT. Please refer to [www.acuitybrands.com/resources/buy-american](http://www.acuitybrands.com/resources/buy-american) for additional information.

### WARRANTY

Five-year limited warranty. Complete warranty terms located at [www.acuitybrands.com/CustomerResources/Terms\\_and\\_conditions.aspx](http://www.acuitybrands.com/CustomerResources/Terms_and_conditions.aspx).

**Note:** Actual performance may differ as a result of end-user environment and application. All values are design or typical values, measured under laboratory conditions at 25 °C. Specifications subject to change without notice.

Luminaire Symbol	Schedule Qty	Label	Description
☐	3	OL2	LUMARK PPRV-2-C40-T4-25
☐	3	ADD	LUMARK PRV-C25-D-UNV-T4-SA-BZ-MSP/DIM-L3

Isoline Legend	
Color	Value
■	0.1
■	0.5
■	1

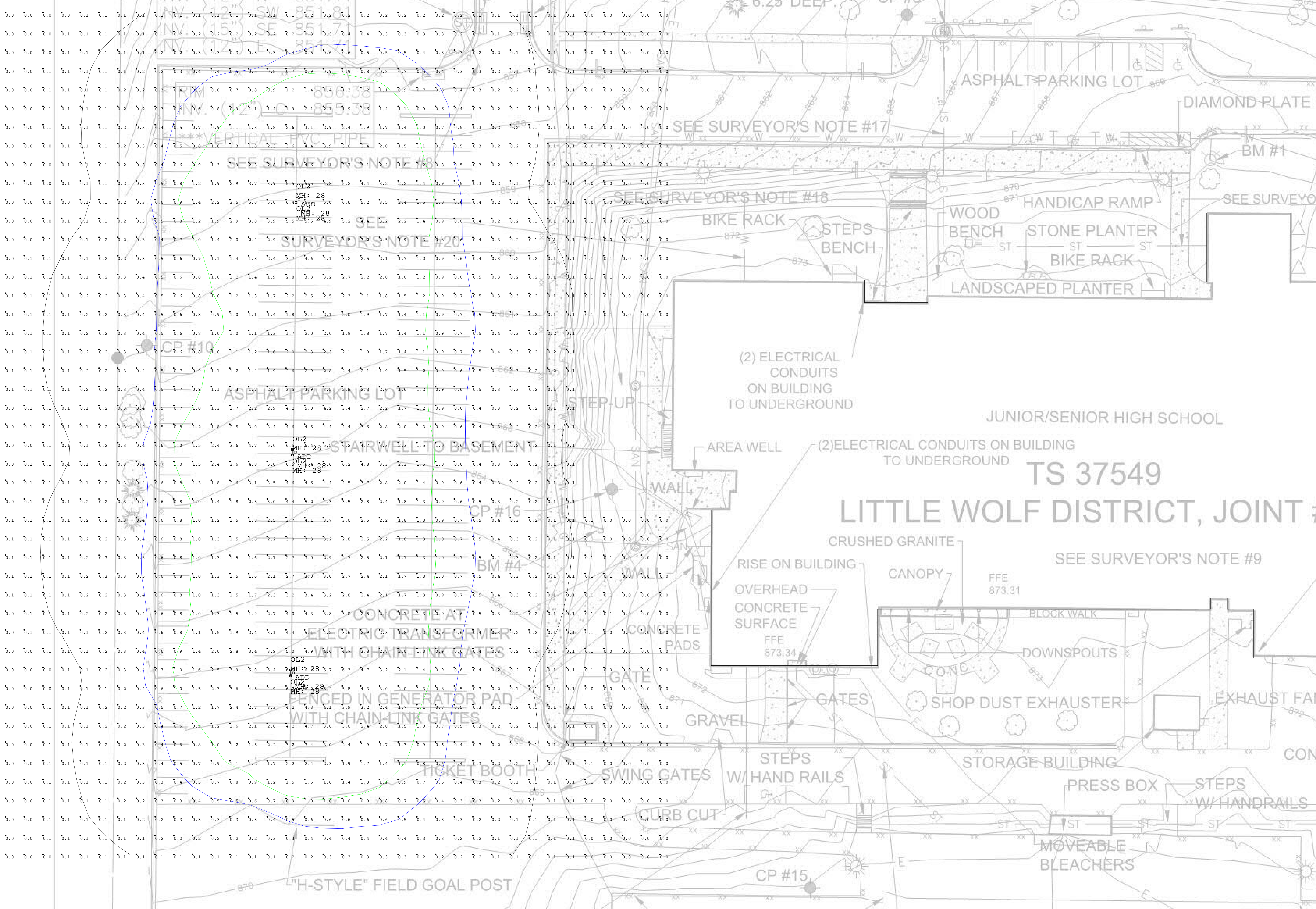

**WERNER**  
ELECTRIC SUPPLY  
4800 W PROSPECT AVENUE APPLETON, WI 54914  
(920) 815-4060 (920) 815-4060 FAX WWW.WERNERELECTRIC.COM

MANAWA HIGH SCHOOL  
PARKING LOT

RECORDS INFO  
DRAWN BY: CRH  
Date: 3/10/2022  
SCALE: N/A  
JOB #: 58790

SHEET DESCRIPTION  
SITE LIGHTING LAYOUT

SHEET NO.  
**ES01**



Luminaire Symbol	Schedule Qty	Label	Description	Isoline Legend Illuminance (Fc)
[Symbol]	3	OL2	LUMARK PPRV-2-C40-T4-25	Color Value
[Symbol]	5	WP	LITHONIA DSXW2 LED 30C 700 40K TFTM MVOL	0.1
				0.5
				1

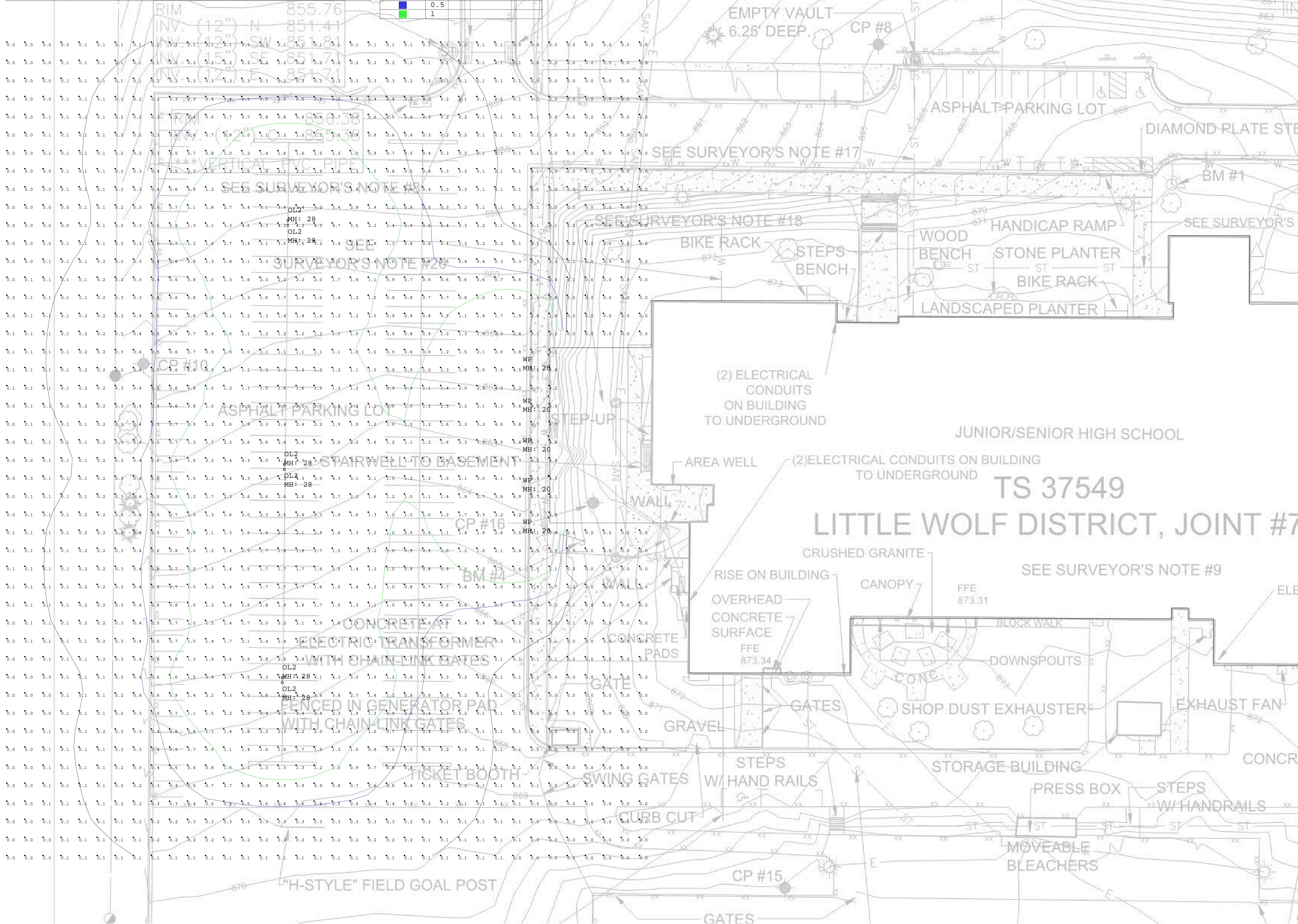

Project		Catalog #		Type	
Prepared by		Notes		Date	



# Lumark

## PRV / PRV-XL Prevail LED

Area / Site Luminaire

### Product Features



### Product Certifications



### Interactive Menu

- Ordering Information [page 2](#)
- Mounting Details [page 3](#)
- Optical Configurations [page 3](#)
- Product Specifications [page 3](#)
- Energy and Performance Data [page 4](#)
- Control Options [page 5](#)

### Quick Facts

- Lumen packages range from 7,100 - 48,600 lumens (50W - 350W)
- Replaces 70W up to 1,000W HID equivalents
- Efficacies up to 148 lumens per watt
- Energy and maintenance savings up to 85% versus HID solutions
- Standard universal quick mount arm with universal drill pattern

### Connected Systems

- WaveLinx
- Enlighted

### Dimensional Details

Prevail

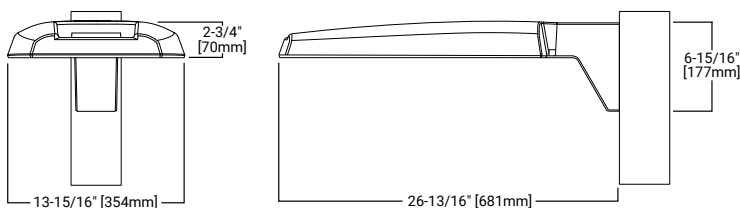

Prevail XL

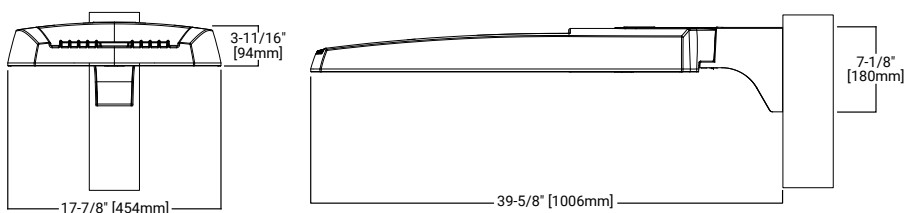

Ordering Information

SAMPLE NUMBER: PRV-XL-C75-D-UNV-T4-SA-BZ

Product Family <sup>1,2</sup>	Light Engine <sup>3</sup>	Driver	Voltage	Distribution	Mounting (Included)	Color
PRV=Prevail	C15=(1 LED) 7,100 Nominal Lumens C25=(2 LEDs) 13,100 Nominal Lumens C40=(2 LEDs) 17,100 Nominal Lumens C60=(2 LEDs) 20,000 Nominal Lumens	D=Dimming (0-10V)	UNV=Universal (120-277V) 347=347V 480=480V <sup>4</sup>	T2=Type II T3=Type III T4=Type IV T5=Type V	SA=Standard Versatile Arm MA=Mast Arm WM=Wall Mount Arm	AP=Grey BZ=Bronze BK=Black DP=Dark Platinum GM=Graphite Metallic WH=White
PRV-XL=Prevail XL	C75=(4 LED) 26,100 Nominal Lumens C100=(4 LED) 31,000 Nominal Lumens C125=(4 LED) 36,000 Nominal Lumens C150=(6 LED) 41,100 Nominal Lumens C175=(6 LED) 48,600 Nominal Lumens					

Options (Add as Suffix)	Accessories (Order Separately) <sup>18</sup>
<p>7030=70 CRI / 3000K CCT <sup>5</sup>                      7035=70CRI / 3500K CCT <sup>5</sup>                      7050=70 CRI / 5000K CCT <sup>5</sup>                      HSS=House Side Shield <sup>6</sup>                      L90=Optics Rotated 90° Left                      R90=Optics Rotated 90° Right                      10K=10kV UL 1449 Fused Surge Protective Device                      20MSP=20kV MOV Surge Protective Device                      20K=Series 20kV UL 1449 Surge Protective Device                      HA=50°C High Ambient Temperature <sup>7</sup>                      PER=NEMA 3-PIN Twistlock Photocontrol Receptacle                      PER7=NEMA 7-PIN Twistlock Photocontrol Receptacle                      SPB2=Dimming Occupancy Sensor with Bluetooth Interface, 8'-20' Mounting <sup>24</sup>                      SPB4=Dimming Occupancy Sensor with Bluetooth Interface, 21'-40' Mounting <sup>24</sup>                      MSP/DIM-L12=Integrated Sensor for Dimming Operation, 8' - 12' Mounting Height <sup>8,9</sup>                      MSP/DIM-L30=Integrated Sensor for Dimming Operation, 12' - 30' Mounting Height <sup>8,9</sup>                      MSP-L12=Integrated Sensor ON/OFF Operation, 8' - 12' Mounting Height <sup>8,9</sup>                      MSP-L30=Integrated Sensor ON/OFF Dimming Operation, 12' - 30' Mounting Height <sup>8,9</sup>                      MS/DIM-L20=Motion Sensor for Dimming Operation, 9' - 20' Mounting Height <sup>9,10</sup>                      MS/DIM-L40W=Motion Sensor for Dimming Operation, 21' - 40' Mounting Height <sup>9,10</sup>                      MS-L20=Motion Sensor for ON/OFF Operation, 9' - 20' Mounting Height <sup>9,10</sup>                      MS-L40W=Motion Sensor for ON/OFF Operation, 21' - 40' Mounting Height <sup>9,10</sup>                      ZD=DALI-enabled 4-PIN Twistlock Receptacle <sup>9,11,12</sup>                      ZW=Wavelinx-enabled 4-PIN Twistlock Receptacle <sup>9,11,12</sup>                      SWPD4XX=Wavelinx Wireless Sensor, 7' - 15' Mounting Height <sup>9,11,12,13,14</sup>                      SWPD5XX=Wavelinx Wireless Sensor, 15' - 40' Mounting Height <sup>9,11,12,13,14</sup>                      LWR-LW=Enlighted Wireless Sensor, Wide Lens for 8' - 16' Mounting Height <sup>9,15</sup>                      LWR-LN=Enlighted Wireless Sensor, Narrow Lens for 16' - 40' Mounting Height <sup>9,15</sup>                      (See Table Below)=LumenSafe Integrated Network Security Camera <sup>16,17</sup>                      CC=Coastal Construction <sup>23</sup></p>	<p>PRVWM-XX=Wall Mount Kit <sup>8</sup>                      PRVMA-XX=Mast Arm Mounting Kit <sup>8</sup>                      PRVSA-XX=Standard Arm Mounting Kit <sup>8</sup>                      PRVXLSA-XX=Standard Arm Mounting Kit (for Prevail XL) <sup>16</sup>                      PRVXLWM-XX=Wall Mount Kit (for Prevail XL) <sup>16</sup>                      PRVXLMA-XX=Mast Arm Mounting Kit (for Prevail XL) <sup>16</sup>                      MA1010-XX=Single Tenon Adapter for 3-1/2" O.D. Tenon                      MA1011-XX=2@180° Tenon Adapter for 3-1/2" O.D. Tenon                      MA1017-XX=Single Tenon Adapter for 2-3/8" O.D. Tenon                      MA1018-XX=2@180° Tenon Adapter for 2-3/8" O.D. Tenon                      HS/VERD=House Side Shield <sup>6,19</sup>                      VGS-F/B=Vertical Glare Shield, Front/Back <sup>19</sup>                      VGS-SIDE=Vertical Glare Shield, Side <sup>19</sup>                      OA/RA1013=Photocontrol Shorting Cap                      OA/RA1014=NEMA Photocontrol - 120V                      OA/RA1016=NEMA Photocontrol - Multi-Tap 105-285V                      OA/RA1201=NEMA Photocontrol - 347V                      OA/RA1027=NEMA Photocontrol - 480V                      ISHH-01=Integrated Sensor Programming Remote <sup>20</sup>                      FSIR-100=Wireless Configuration Tool for Occupancy Sensor <sup>21</sup>                      SWPD4-XX=WaveLinX Wireless Sensor, 7' - 15' Mounting Height <sup>12,13,14</sup>                      SWPD5-XX=WaveLinX Wireless Sensor, 15' - 40' Mounting Height <sup>12,13,14</sup>                      WOLC-7P-10A=WaveLinX Outdoor Control Module (7-PIN) <sup>22</sup></p>

**NOTES:**

- DesignLights Consortium® Qualified. Refer to [www.designlights.org](http://www.designlights.org) Qualified Products List under Family Models for details.
- Customer is responsible for engineering analysis to confirm pole and fixture compatibility for applications. Refer to installation instructions and pole white paper WP513001EN for additional support information.
- Standard 4000K CCT and 70CRI.
- Only for use with 480V Wye systems. Per NEC, not for use with ungrounded systems, impedance grounded systems or corner grounded systems (commonly known as Three Phase Three Wire Delta, Three Phase High Leg Delta and Three Phase Corner Grounded Delta systems).
- Use dedicated IES files on product website for non-standard CCTs.
- Option will come factory-installed. House Side Shield not suitable with T5 distribution or C60 lumen package.
- Not available with C60 lumen package.
- Only available in PRV configurations C15, C25, C40 or C60.
- Controls system is not available with photocontrol receptacle (PER or PER7) or other controls systems (MS, MSP, ZW, ZD or LWR).
- Utilizes the Wattstopper sensor FSP-211.
- Sensor passive infrared (PIR) may be overly sensitive when operating below -20°C (-4°F).
- For the device to be field-configurable, requires WAC Gateway components WAC-PoE and WPOE-120 in appropriate quantities. Only compatible with WaveLinX system and software and requires system components to be installed for operation. See website for more Wavelinx application information.
- Replace XX with sensor color (WH, BZ, or BK).
- Requires 4-PIN twistlock receptacle (ZD or ZW) option.
- Enlighted wireless sensors are factory installed and require network components LWP-EM-1, LWP-GW-1, and LWP-PoE8 in appropriate quantities. See website for application information.
- Only available in PRV-XL configurations C75, C100, C125, C150, or C175.
- Not available with 347V, 480V, or HA options. Consult LumenSafe system product pages for additional details and compatibility information.
- Replace XX with paint color.
- Must order one per optic/LED when ordering as a field-installable accessory (1, 2, 4, or 6).
- This tool enables adjustment to Integrated Sensor (MSP) parameters including high and low modes, sensitivity, time delay, cutoff and more. Consult your lighting representative at Cooper Lighting Solutions for more information.
- This tool enables adjustment to Motion Sensor (MS) parameters including high and low modes, sensitivity, time delay, cutoff and more. Consult your lighting representative at Cooper Lighting Solutions for more information.
- Requires 7-PIN NEMA twistlock photocontrol receptacle (PER7) option. The WOLC-7 cannot be used in conjunction with other controls systems (MS, MSP, ZW, ZD or LWR). Operates on 120-347V input voltages.
- Coastal construction finish salt spray tested to over 5,000-hours per ASTM B117, with a scribe rating of 9 per ASTM D1654.
- Smart device with mobile application required to change system defaults. See controls section for details.

LumenSafe Integrated Network Security Camera Technology Options (Add as Suffix)

Product Family	Camera Type	Data Backhaul
<p>L=LumenSafe Technology</p> 	D=Dome Camera	<p>C=Cellular, Customer Installed SIM Card                      A=Cellular, Factory Installed AT&amp;T SIM Card                      V=Cellular, Factory Installed Verizon SIM Card                      S=Cellular, Factory Installed Sprint SIM Card</p> <p>E=Ethernet Networking</p>

Stock Ordering Information

Product Family <sup>1</sup>	Light Engine	Voltage	Distribution	Options (Add as Suffix)
PRVS=Prevail	C15=(1 LED) 7,100 Nominal Lumens C25=(2 LEDs) 13,100 Nominal Lumens C40=(2 LEDs) 17,100 Nominal Lumens C60=(2 LEDs) 20,000 Nominal Lumens	UNV=Universal (120-277V) 347=347V <sup>2</sup>	T3=Type III T4=Type IV	MSP/DIM-L30=Integrated Sensor for Dimming Operation, Maximum 30' Mounting Height <sup>2</sup>
PRVS-XL=Prevail XL	C75=(4 LED) 26,100 Nominal Lumens C100=(4 LED) 31,000 Nominal Lumens C125=(4 LED) 36,000 Nominal Lumens C150=(6 LED) 41,100 Nominal Lumens C175=(6 LED) 48,600 Nominal Lumens			

**NOTES:**

- All stock configurations are standard 4000K/70CRI, bronze finish, and include the standard versatile mounting arm.
- Only available in PRVS configurations C15, C25, C40 or C60.

Mounting Details

Pole Mount Arm (PRV)

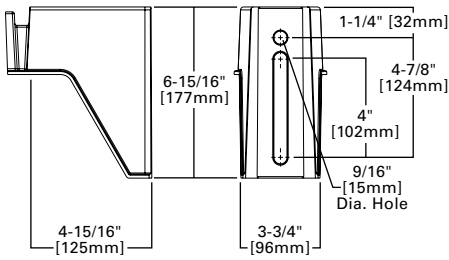

Pole Mount Arm (PRV-XL)

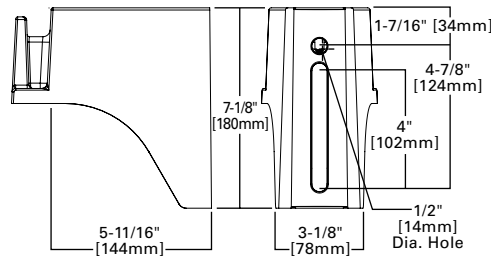

Versatile Mount System

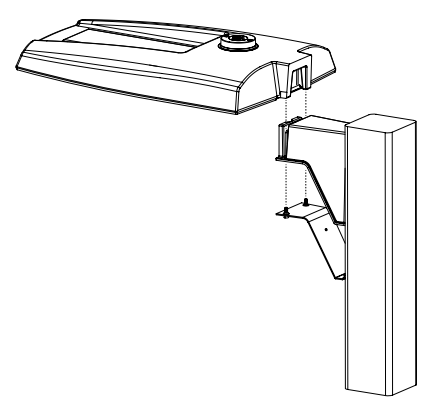

Wall Mount (PRV)

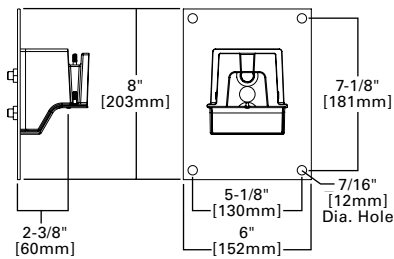

Wall Mount (PRV-XL)

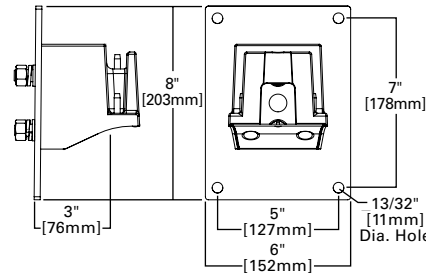

Mast Arm Mount (PRV)

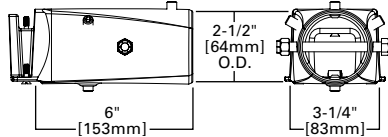

Mast Arm Mount (PRV-XL)

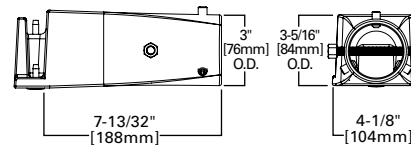

Mounting Configurations and EPAs

NOTE: For 2 PRV's mounted at 90°, requires minimum 3" square or 4" round pole for fixture clearance. For 2 PRV-XL's mounted at 90°, requires minimum 4" square or round pole for fixture clearance. Customer is responsible for engineering analysis to confirm pole and fixture compatibility for applications.

<b>Wall Mount</b>	<b>Arm Mount Single</b> EPA 0.92 (PRV) EPA 1.12 (PRV-XL)	<b>Arm Mount 2 @ 180°</b> EPA 1.35 (PRV) EPA 2.25 (PRV-XL)	<b>Arm Mount 2 @ 90°</b> EPA 1.42 (PRV) EPA 2.13 (PRV-XL)	<b>Arm Mount 3 @ 90°</b> EPA 1.63 (PRV) EPA 2.52 (PRV-XL)	<b>Arm Mount 4 @ 90°</b> EPA 1.63 (PRV) EPA 2.52 (PRV-XL)
-------------------	--	--	---	---	---

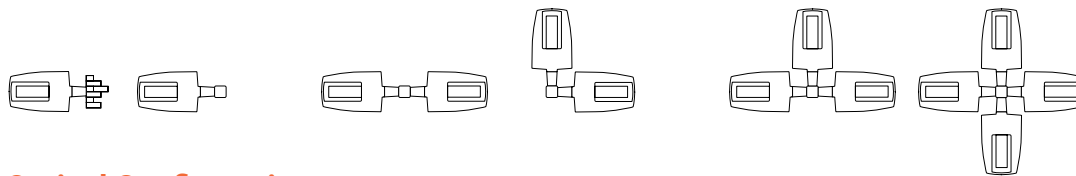

Optical Configurations

<b>PRV-C15</b> (7,100 Nominal Lumens)	<b>PRV-C25/C40/C60</b> (13,100/17,100/20,000 Nominal Lumens)	<b>PRV-XL-C75/C100/C125</b> (26,100/31,000/36,300 Nominal Lumens)	<b>PRV-XL-C150/C175</b> (41,100/48,600 Nominal Lumens)
--	---	--	---

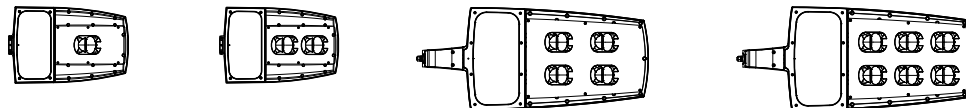

Product Specifications

Construction

- Single-piece die-cast aluminum housing
- Tethered die-cast aluminum door

Optics

- Dark Sky Approved (3000K CCT and warmer only)
- Precision molded polycarbonate optics

Electrical

- -40°C minimum operating temperature
- 40°C maximum operating temperature
- >.9 power factor
- <20% total harmonic distortion

- Class 1 electronic drivers have expected life of 100,000 hours with <1% failure rate
- 0-10V dimming driver is standard with leads external to the fixture

Mounting

- Versatile, patented, standard mount arm accommodates multiple drill patterns ranging from 1-1/2" to 4-7/8"
- A knock-out on the standard mounting arm enables round pole mounting
- Prevail: 3G vibration rated
- Prevail XL Mast Arm: 3G vibration rated
- Prevail XL Standard Arm: 1.5G vibration rated

Finish

- Five-stage super TGIC polyester powder coat paint, 2.5 mil nominal thickness

Shipping Data

- Prevail: 20 lbs. (9.09 kgs.)
- Prevail XL: 45 lbs. (20.41 kgs.)

## Energy and Performance Data

### Power and Lumens (PRV)

 [View PRV IES files](#)

Light Engine	C15	C25	C40	C60	
<b>Power (Watts)</b>	52	96	131	153	
<b>Input Current @ 120V (A)</b>	0.43	0.80	1.09	1.32	
<b>Input Current @ 277V (A)</b>	0.19	0.35	0.48	0.57	
<b>Input Current @ 347V (A)</b>	0.17	0.30	0.41	0.48	
<b>Input Current @ 480V (A)</b>	0.12	0.22	0.30	0.35	
<b>Distribution</b>					
<b>Type II</b>	4000K Lumens	7,123	13,205	17,172	20,083
	BUG Rating	B2-U0-G2	B2-U0-G2	B3-U0-G3	B3-U0-G3
	3000K Lumens	6,994	12,965	16,860	19,718
<b>Type III</b>	4000K Lumens	7,111	13,183	17,144	20,050
	BUG Rating	B1-U0-G2	B2-U0-G3	B3-U0-G4	B3-U0-G4
	3000K Lumens	6,982	12,944	16,832	19,686
<b>Type IV</b>	4000K Lumens	7,088	13,140	17,087	19,984
	BUG Rating	B1-U0-G3	B2-U0-G4	B2-U0-G4	B3-U0-G5
	3000K Lumens	6,959	12,901	16,777	19,621
<b>Type V</b>	4000K Lumens	7,576	14,045	18,264	21,360
	BUG Rating	B3-U0-G3	B4-U0-G3	B4-U0-G4	B5-U0-G4
	3000K Lumens	7,438	13,790	17,932	20,972

### Lumen Maintenance

Configuration	TM-21 Lumen Maintenance (50,000 Hours)	Theoretical L70 (Hours)
Up to PRV-C60 at 25°C	91.30%	194,000
Up to PRV-C60 at 40°C	87.59%	134,000
Up to PRV-XL-C175 at 25°C	91.40%	204,000
Up to PRV-XL-C175 at 40°C	89.41%	158,000

### Lumen Multiplier

Ambient Temperature	Lumen Multiplier
10°C	1.02
15°C	1.01
25°C	1.00
40°C	0.99

### Power and Lumens (PRV-XL)

 [View PRV-XL IES files](#)

Light Engine	C75	C100	C125	C150	C175	
<b>Power (Watts)</b>	176	217	264	285	346	
<b>Input Current @ 120V (A)</b>	1.50	1.84	2.21	2.38	2.92	
<b>Input Current @ 277V (A)</b>	0.66	0.82	0.97	1.04	1.25	
<b>Input Current @ 347V (A)</b>	0.54	0.66	0.79	0.84	1.02	
<b>Input Current @ 480V (A)</b>	0.40	0.48	0.57	0.62	0.74	
<b>Distribution</b>						
<b>Type II</b>	4000K Lumens	26,263	31,231	36,503	41,349	48,876
	BUG Rating	B3-U0-G3	B3-U0-G4	B4-U0-G4	B4-U0-G4	B4-U0-G5
	3000K Lumens	25,786	30,664	35,840	40,598	47,989
<b>Type III</b>	4000K Lumens	26,120	31,061	36,304	41,124	48,610
	BUG Rating	B3-U0-G5	B3-U0-G5	B3-U0-G5	B4-U0-G5	B4-U0-G5
	3000K Lumens	25,646	30,497	35,645	40,377	47,727
<b>Type IV</b>	4000K Lumens	26,098	31,035	36,274	41,089	48,569
	BUG Rating	B3-U0-G5	B3-U0-G5	B3-U0-G5	B3-U0-G5	B4-U0-G5
	3000K Lumens	25,624	30,471	35,615	40,343	47,687
<b>Type V</b>	4000K Lumens	28,129	33,450	39,097	44,287	52,349
	BUG Rating	B5-U0-G5	B5-U0-G5	B5-U0-G5	B5-U0-G5	B5-U0-G5
	3000K Lumens	27,618	32,843	38,387	43,483	51,398

Control Options

**0-10V (D)** The dimming option provides 0-10V dimming wire leads for use with a lighting control panel or other control method.

**Photocontrol (PER and PER7)** Photocontrol receptacles provide a flexible solution to enable "dusk-to-dawn" lighting by sensing light levels. Advanced control systems compatible with NEMA 7-pin standards can be utilized with the PER7 receptacle.

**Dimming Occupancy Sensor (SPB, MSP and MS)** These sensors are factory installed in the luminaire housing. When a sensor for dimming operation (/DIM) option is selected, the luminaire will dim down to approximately 50 percent power after five minutes of no activity detected. When activity is detected, the luminaire returns to full light output. When a sensor for ON/OFF operation is selected, the luminaire will turn off after five minutes of no activity. The SPB is factory preset to dim down to 10% power with a time delay of five minutes. To reconfigure the SPB, the Sensor Configuration application by Wattstopper for iOS and Android devices is required to change factory default dimming level, time delay, sensitivity and other parameters.

These occupancy sensors include an integral photocell that can be activated or inactivated with the programming remote / configuration tool for "dusk-to-dawn" control or "daylight harvesting". **Note:** For MSP sensors, the factory preset is ON (Enabled), and for MS sensors, the factory preset is OFF (Disabled). The programming remote / tool is a wireless tool that can be utilized to change the dimming level, time delay, sensitivity and other parameters. A variety of sensor lenses are available to optimize the coverage pattern for mounting heights from 8'-40'.

For mounting heights from 8' to 12' (-L12)

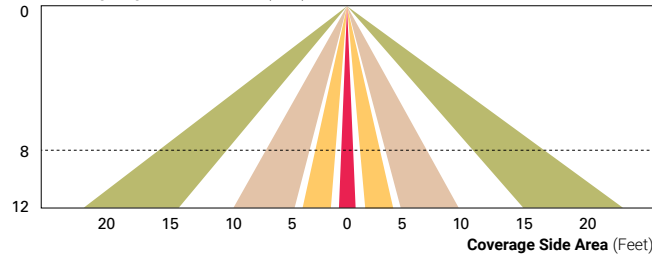

For mounting heights from 12' to 30' (-L30)

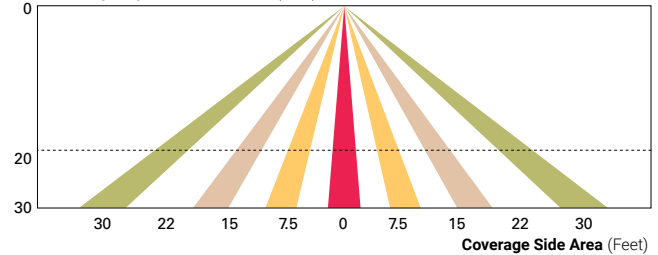

For mounting heights from 9' to 20' (-L20)

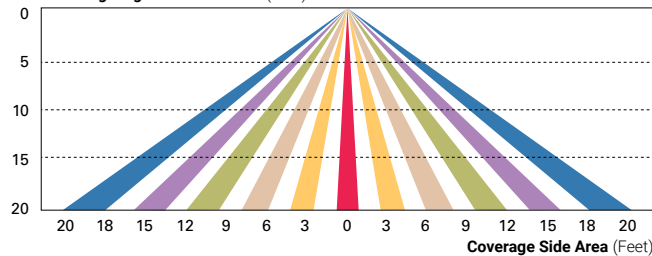

For mounting heights from 21' to 40' (-L40W)

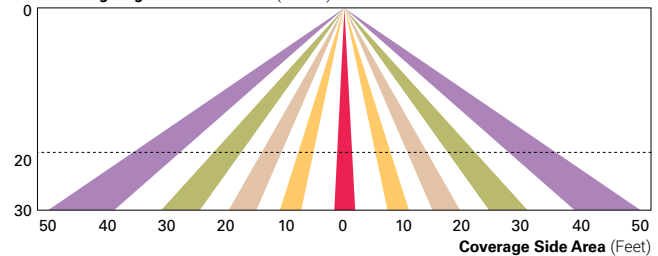

**WaveLinx Wireless Control and Monitoring System** Available in 7-PIN or 4-PIN configurations, the WaveLinx Outdoor control platform operates on a wireless mesh network based on IEEE 802.15.4 standards enabling wireless control of outdoor lighting. Use the WaveLinx Mobile application for set-up and configuration. At least one Wireless Area Controller (WAC) is required for full functionality and remote communication (including adjustment of any factory pre-sets).

**WaveLinx Outdoor Control Module (WOLC-7P-10A)** A photocontrol that enables astronomical or time-based schedules to provide ON, OFF and dimming control of fixtures utilizing a 7-PIN receptacle. The out-of-box functionality is ON at dusk and OFF at dawn.

**WaveLinx Wireless Sensor (SWPD4 and SWPD5)** These outdoor sensors offer passive infrared (PIR) occupancy and a photocell for closed loop daylight sensing. These sensors can be factory installed or field-installed via simple, tool-less integration into luminaires equipped with the Zhaga Book 18 compliant 4-PIN receptacle (ZD or ZW). These sensors are factory preset to dim down to approximately 50 percent power after 15 minutes of no activity detected. These occupancy sensors include an integral photocell for "dusk-to-dawn" control or daylight harvesting that is factory-enabled. A variety of sensor lenses are available to optimize the coverage pattern for mounting heights from 7'-40'.

For mounting heights from 16' to 40' (SWPD)

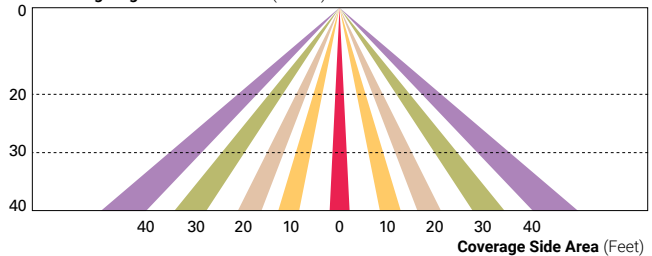

**Enlighted Wireless Control and Monitoring System (LWR-LW and LWR-LN)** The Enlighted System is a connected lighting solution that combines LED luminaires with an integrated wireless sensor system. The sensor controls the lighting system in compliance with the latest energy codes and collects valuable data about building performance and use. Software applications turn the granular data into information through energy dashboards and specialized apps that make it simple and help optimize the use of other resources beyond lighting.

For mounting heights from 8' to 16' (LWR-LW)

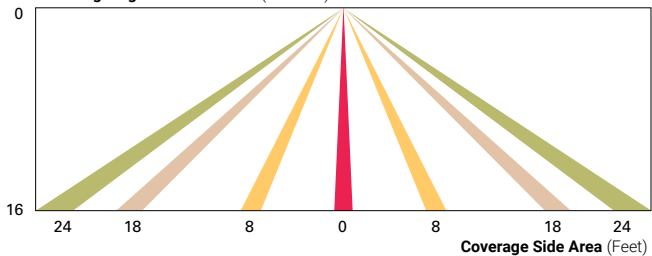

For mounting heights from 16' to 40' (LWR-LN)

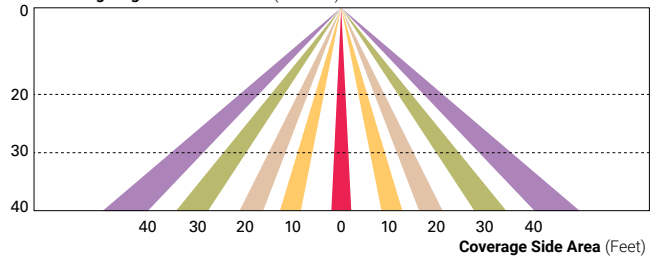

**LumenSafe (LD)** The LumenSafe integrated network camera is a streamlined, outdoor-ready camera that provides high definition video surveillance. This IP camera solution is optimally designed to integrate into virtually any video management system or security software platform of choice. No additional wiring is needed beyond providing line power to the luminaire. LumenSafe features factory-installed power and networking gear in a variety of networking options allowing security integrators to design the optimal solution for active surveillance.



**Students choosing to excel; realizing their strengths.**

To: Board of Education – Buildings & Grounds Committee  
From: Dr. Melanie J. Oppor  
Date: April 12, 2022  
Re: Recommendation for Long Jump/Triple Jump Runways

The purpose of this memo is to recommend that the Manawa Board of Education approve the Long Jump/Triple Jump Dual Runways abutting one another on a single concrete slab. Further, it is recommended that the Manawa Board of Education divert \$9,569 from the unused 2021-22 snow removal budget added to the donated funds of the Manawa Athletic Booster Club to pay for the complete project.

**Rationale:**

- Per Fisher Track, 99% of runways are designed abutting one another.
- Having two separate runways with some sort of material between can lead to more chances for debris to get onto the runway which could cause injuries to athletes or damage the surface of the runway.
- If the existing sandpits are not retrofitted to 23', the WIAA may not be able to sanction the SDM hosting Track and Field events in the future as per WIAA Track & Field expert Kate Peterson Abiad. (It would be permitted presently.)
- Runways constructed after 2019 must adhere to the new National Federation of State High School Associations (NFHS) for the longer 23' sandpits.

The cost breakdown for this project is as follows:

<i>Vendor</i>	<i>Cost</i>
Fisher Track – resurfacing existing track & runway	\$126,687
Fisher Track – resurfacing newly installed runway (11' X 146')	\$4,360
Spiegelberg – concrete work for added runway (11' X 146'); retrofitting existing sandpits to 23'	\$18,522
<b>Total for Complete Project</b>	<b>\$149,569</b>
Donation from Manawa Athletic Booster Club	\$140,000
<b>Difference Paid by SDM</b>	<b>\$9,569</b>

The Buildings & Grounds 2021-22 snow removal budget currently has \$24,703.85 remaining in that line item.



**BID PROPOSAL**

**DATE:** April 11, 2022

**TO:** Dr. Melanie Oppor  
District Administrator  
School District of Manawa

**PROJECT:** High School Track  
(New Long/Triple Jump Runway)

**BID INCLUDES**

Application of a black **FT Poly Mat 5K** – a cast-in-place, durable, resilient, all-weather, running track surface consisting of polyurethane bound rubber base mat. The thickness of the rubber surface shall be 13mm.

Materials, equipment and installation by Fisher Tracks, Inc.

Bid includes the application to the 11' x 146' new long/triple jump runway

**\*FT POLY MAT 5K PRICE: -----\$4,360.00**

**\*Price is based on installation performed in conjunction with track surfacing project.**

**Notes:**

1. Add 1% if Fisher Tracks, Inc. is to provide a performance bond.
2. Bid is based on a 2022 installation.
3. Price does not include sales or use tax if applicable
4. Fisher Tracks, Inc is a member of the America Sports Builders Association and has (3) Certified Track Builders on staff.

**BY:**

  
Darin Olofson, CTB  
Track Consultant  
Fisher Tracks, Inc.



Fisher Tracks, Inc.  
1192 235th Street • Boone, IA 50036  
800-432-3191 • 515-432-3191 • FAX 515-432-3193  
[www.fishertracks.com](http://www.fishertracks.com)







**BID PROPOSAL**

**DATE:** April 12, 2022

**TO:** Dr. Melanie Oppor  
District Administrator  
School District of Manawa

**PROJECT:** High School Track  
(New Long/Triple Jump Runway)

**BID INCLUDES**

Application of a black **FT Poly Mat 5K** – a cast-in-place, durable, resilient, all-weather, running track surface consisting of polyurethane bound rubber base mat. The thickness of the rubber surface shall be 13mm.

Materials, equipment and installation by Fisher Tracks, Inc.

Bid includes the application to the 5' x 146' new long/triple jump runway

**\*FT POLY MAT 5K PRICE: -----\$1,852.00**

**\*Price is based on installation performed in conjunction with track surfacing project.**

**Notes:**

1. Add 1% if Fisher Tracks, Inc. is to provide a performance bond.
2. Bid is based on a 2022 installation.
3. Price does not include sales or use tax if applicable
4. Fisher Tracks, Inc is a member of the America Sports Builders Association and has (3) Certified Track Builders on staff.

**BY:**

**Darin Olofson, CTB  
Track Consultant  
Fisher Tracks, Inc.**



Fisher Tracks, Inc.  
1192 235th Street • Boone, IA 50036  
800-432-3191 • 515-432-3191 • FAX 515-432-3193  
[www.fishertracks.com](http://www.fishertracks.com)





E5750 Hwy 54  
 Weyauwega WI 54983  
 Office: 920.596.2610  
 Scott Spiegelberg: 920.538.0642  
 Jordan Spiegelberg: 920.538.0392  
[www.spiegelberginc.com](http://www.spiegelberginc.com)

Date: 4/11/2022 Project: Long Jump Runway & 2 Pits  
 Customer: Melanie Oppor mopper@manawaschools.org Description: 11' x 146' Runway  
 Contact: Patric 608-434-3573 Location: Manawa

Qty	Finished Concrete Work	Cost	Total
0	Sq. ft. of 4" Interior Flatwork, cost to Pour and Power Trowel Finish		
0	Sq. ft. of 4" Exterior Flatwork, cost to Pour and Broom Finish		
1606	<b>Sq. ft. of 4" Exterior Flatwork, cost to Pour and Broom Finish ( 11' x 146' runway)</b>		
0	Sq.ft. of 4" Exterior Flatwork, cost to Pour and Stamp Concrete		
25	<b>Cost per yard of concrete (#4000 PSI) for flatwork</b>		
0	Cost per yard of concrete (#4000 PSI 6 bag Special Finishing Mix)		
5	<b>Cost Per Concrete Truck, Fuel Surcharge Allowance.</b>		
0	Concrete Winter Heat Charge Allowance (Concrete poured Nov. 1 to April 1)		
0	Color for Concrete allowance (\$15 - \$100 yard)		
0	Cost per Cement Truck to wash out from colored concrete.		
0	Concrete Pump Allowance Per Yard		
0	Concrete Power Buggy Allowance		
0	Ft. of 10" x 20" Perimeter Grade Beam with Continuous Runs of #4 Rebar		
0	Ft. of 8" x 4' Frost Wall and Footing		
124	<b>Ft. of 12" x 12" Curb (extend existing pit and make new 23' long)</b>		
	<b>Extras:</b>		
0	4" x 6' Galvanized Guard Post Installed		
0	6 5/8" x 6'8" Steel Guard Post Installed and Filled With Concrete		
0	Sq. Ft. of TK AS-1 Cure and Seal, Interior Sealer Installed		
0	Sq. Ft. of TK 26UV Cure and Seal, Exterior Sealer Installed		
0	Sheets of 2" Foam Insulation for under Floor (by )		
0	Sheets of 2" Foam Insulation for Perimeter of Foundation (by )		
0	Sq. Ft. of Vapor Barrier Installed		
0	Lf. Ft. of Expansion Joint		
0	Ft. of Polymar Trench Drain Allowance (Plumbing by Plumber)		
1	<b>Excavation Work Allowance</b>		
0	Concrete Disposal / Hauling Allowance		
2	<b>Loads of Gravel Allowance</b>		
1	Job Setup / Travel		
	<b>Reinforcement Options:</b>		
0	Cost per sq. ft. for 10 Gauge Wire Mesh		
0	Cost per sq. ft. for 6 gauge Wire Mesh sheets		
0	Cost per sq. ft. for #4 rebar 36" OC tied		
0	Cost per sq. ft. for #3 rebar 24" OC tied		
0	Cost per sq. ft. for #4 rebar 24" OC tied		
0	Cost per sq. ft. for #4 rebar 18" OC tied		
25	<b>Cost per yard for 1.5 lbs. Forta Fiber</b>		
0	Cost per yard for 3 lbs. Forta Fiber		
800	<b>Cost per ft of extra rebar installed</b>		
	<b>Project Total</b>		<b>\$ 18,522.00</b>

**Note:**

Owner is responsible for all excavation, digging, backfilling and fill compacted in place  
 There must be a accessible driveway for concrete pump and trucks for pouring.  
 Our Proposal Includes Fine Grading The Site To Ensure Uniform and Consistent Concrete Thickness

*For A Job Done Right!*



E5750 Hwy 54  
 Weyauwega WI 54983  
 Office: 920.596.2610  
 Scott Spiegelberg: 920.538.0642  
 Jordan Spiegelberg: 920.538.0392  
[www.spiegelberginc.com](http://www.spiegelberginc.com)

Date: 4/11/2022 Project: Long Jump Runway & 2 Pits  
 Customer: Melanie Oppor mopper@manawaschools.org Description: 6' x 146 Runway  
 Contact: Patric 608-434-3573 Location: Manawa

Qty	Finished Concrete Work	Cost	Total
0	Sq. ft. of 4" Interior Flatwork, cost to Pour and Power Trowel Finish		
0	Sq. ft. of 4" Exterior Flatwork, cost to Pour and Broom Finish		
876	<b>Sq. ft. of 4" Exterior Flatwork, cost to Pour and Broom Finish ( 6' x 146' runway)</b>		
0	Sq.ft. of 4" Exterior Flatwork, cost to Pour and Stamp Concrete		
15	<b>Cost per yard of concrete (#4000 PSI) for flatwork</b>		
0	Cost per yard of concrete (#4000 PSI 6 bag Special Finishing Mix)		
3	<b>Cost Per Concrete Truck, Fuel Surcharge Allowance.</b>		
0	Concrete Winter Heat Charge Allowance (Concrete poured Nov. 1 to April 1)		
0	Color for Concrete allowance (\$15 - \$100 yard)		
0	Cost per Cement Truck to wash out from colored concrete.		
0	Concrete Pump Allowance Per Yard		
0	Concrete Power Buggy Allowance		
0	Ft. of 10" x 20" Perimeter Grade Beam with Continuous Runs of #4 Rebar		
0	Ft. of 8" x 4' Frost Wall and Footing		
124	<b>Ft. of 12" x 12" Curb (extend existing pit and make new 23' long)</b>		
	<b>Extras:</b>		
0	4" x 6' Galvanized Guard Post Installed		
0	6 5/8" x 6'8" Steel Guard Post Installed and Filled With Concrete		
0	Sq. Ft. of TK AS-1 Cure and Seal, Interior Sealer Installed		
0	Sq. Ft. of TK 26UV Cure and Seal, Exterior Sealer Installed		
0	Sheets of 2" Foam Insulation for under Floor (by )		
0	Sheets of 2" Foam Insulation for Perimeter of Foundation (by )		
0	Sq. Ft. of Vapor Barrier Installed		
0	Lf. Ft. of Expansion Joint		
0	Ft. of Polymar Trench Drain Allowance ( Plumbing by Plumber )		
1	<b>Excavation Work Allowance</b>		
0	Concrete Disposal / Hauling Allowance		
4	<b>Loads of Gravel Allowance</b>		
1	Job Setup / Travel		
	<b>Reinforcement Options:</b>		
0	Cost per sq. ft. for 10 Gauge Wire Mesh		
0	Cost per sq. ft. for 6 gauge Wire Mesh sheets		
0	Cost per sq. ft. for #4 rebar 36" OC tied		
0	Cost per sq. ft. for #3 rebar 24" OC tied		
0	Cost per sq. ft. for #4 rebar 24" OC tied		
0	Cost per sq. ft. for #4 rebar 18" OC tied		
15	<b>Cost per yard for 1.5 lbs. Forta Fiber</b>		
0	Cost per yard for 3 lbs. Forta Fiber		
480	<b>Cost per ft of extra rebar installed</b>		
	<b>Project Total</b>		<b>\$ 15,652.60</b>

**Note:**

Owner is responsible for all excavation, digging, backfilling and fill compacted in place  
 There must be a accessible driveway for concrete pump and trucks for pouring.  
 Our Proposal Includes Fine Grading The Site To Ensure Uniform and Consistent Concrete Thickness

*For A Job Done Right!*

Project	Estimated Cost	Notes	Board Approved
Graduation Stage (ADA accessible)	\$35,000.00		3/21/22
MES Playground Equipment	\$150,000.00	Volunteer assembly to save money	
ISONAS door system update	\$29,678.00		3/21/22
Cybersecurity Updates	\$10,000.00	Required to maintain liability insurance coverage.	
Band Uniforms	\$55,000.00		
Handicap accessible auto-operator door - top of Fitness Center stairs	\$6,000.00		
SIS Update (Skyward)	\$15,000.00	for increased efficiency and accuracy - hire Skyward	
LED lighting MES classrooms/hallways	\$92,000.00	HJ Martin is unable to quote work for this year	
MES corridor: floor refinishing, repair expansion joints	\$10,000.00	HJ Martin	
MES Water Bottle Fillers	\$12,000.00	MES Houses (2)	
Bottle Fillers at LWHS - Library	\$6,000.00		
Carpeting & Furnishings for the LWHS/MMS library		HJ Martin	
Furnishings - LWHS/MMS Collaboration Space	\$50,000.00		
Standing Seam Metal Roof at MES		sealant?	
HS/MS student parking lot lighting		B&G	
MES lighting for back playground area		Master Electric	
Strip and polish the terrazo at the high school	\$55,000.00		
Furnishings - LWHS/MMS Commons	\$75,000.00	Could be done in sections	
Furnishings - LWHS/MMS Classroom Furniture	\$100,000.00		
Furnishings - MES House Common Space			
Air Duct/Fume Hood exhaust capabilities in the Engineering & Robotics Design Lab - LWHS		Call Matt (Hoffman) and find out about options	
Furnishings - MES Flexible Classroom Furniture			
MS/HS Scrolling Sign	\$20,000.00	sign and posts	
MES Scrolling Sign	\$25,000.00	need electricity to the road	
Easy-to-Move Furniture for MES library			
Update Boardroom video conf	\$12,000.00	replace camera, mulitple speakers,	
UTV			
Zero-turn lawn mower			

**PROPOSAL NUMBER 24783 DATED 04-06-22**

***MASTER ELECTRICAL SERVICES LLC – FOR ALL YOUR ELECTRICAL NEEDS!***

**PROPOSAL SUBMITTED TO:**

**WORK TO BE PERFORMED AT:**

**NAME:** School District of Manawa  
**ADDRESS:** 800 Beech Street  
Manawa, WI 54949

**LOCATION:** Elementary School

**EMAIL:**

**PHONE NO.:** 920-596-2525

We hereby propose to furnish the materials and perform the labor necessary to wire the following:

- Provide and install (2) wall pack fixtures on East side of school as high as possible.
- In green area East of Maintenance Shop, set a 24" concrete pole base and 25' pole with (2) lights.
- Trench from new pole base back to school with 3/4" PVC conduit, pull wire and tie into existing control.

***Thank you for the opportunity to serve you!***

All material is guaranteed to be as specified, and the above work to be performed in accordance with the drawings and specifications submitted for above work and completed in a substantial workmanlike manner for the sum of:

**Nine thousand six hundred seventy-eight and 83/100** Dollars **(\$ 9,678.83)**

Any alteration or deviation from above specification involving extra costs will become an extra charge over and above the estimate. All agreements are contingent upon strikes, accidents, or delays beyond our controls. This proposal may be withdrawn by MES if not accepted within 5 days. Acceptance of this proposal provides a Personal Guaranty on behalf of the Acceptor and the above-named Company principals who he/she represents.

Due to the current volatility of the commodity markets (steel, copper, aluminum, brass, plastics, oil, etc.), we are not able to hold firm prices on materials or products for release any further out than factories or suppliers will guarantee. **PRICE IS GOOD AT TIME AND DATE OF ESTIMATE ONLY.** If this proposal is open beyond (30) days, contact us to establish revised pricing.

All materials shall remain the property of Master Electrical Services until paid in full. Customer will be responsible for any and all costs of collection, including, but not limited to, reasonable attorney's fees and filing fees for court actions.

The information and data contained is provided to you as an instrument of service, and intended for use and reference relative only to the specific project they describe. The information may not be copied, modified or released to a third party without the direct written permission of M.E.S. By acceptance of this information, you agree to this confidentiality clause.

**Percentage of completion payments respectfully submitted: MASTER ELECTRICAL SERVICES LLC.**  
**A 1.5% Service Charge will be added to all balances over 30 days.**

Per: \_\_\_\_\_  
Dave Mackowiak (sls)

.....  
**ACCEPTANCE OF PROPOSAL**  
.....

The above prices, specifications, and conditions are satisfactory and are hereby accepted. You are authorized to do the work as specified above.

Signature \_\_\_\_\_ Date \_\_\_\_\_

***Master Electrical Services LLC***  
***1913 Mill Street, New London, Wisconsin 54961***  
***(920) 982-6467 FAX (920) 982-6484***  
***General e-mail: [general@master-electric.net](mailto:general@master-electric.net)***

of  
No  
-0.10

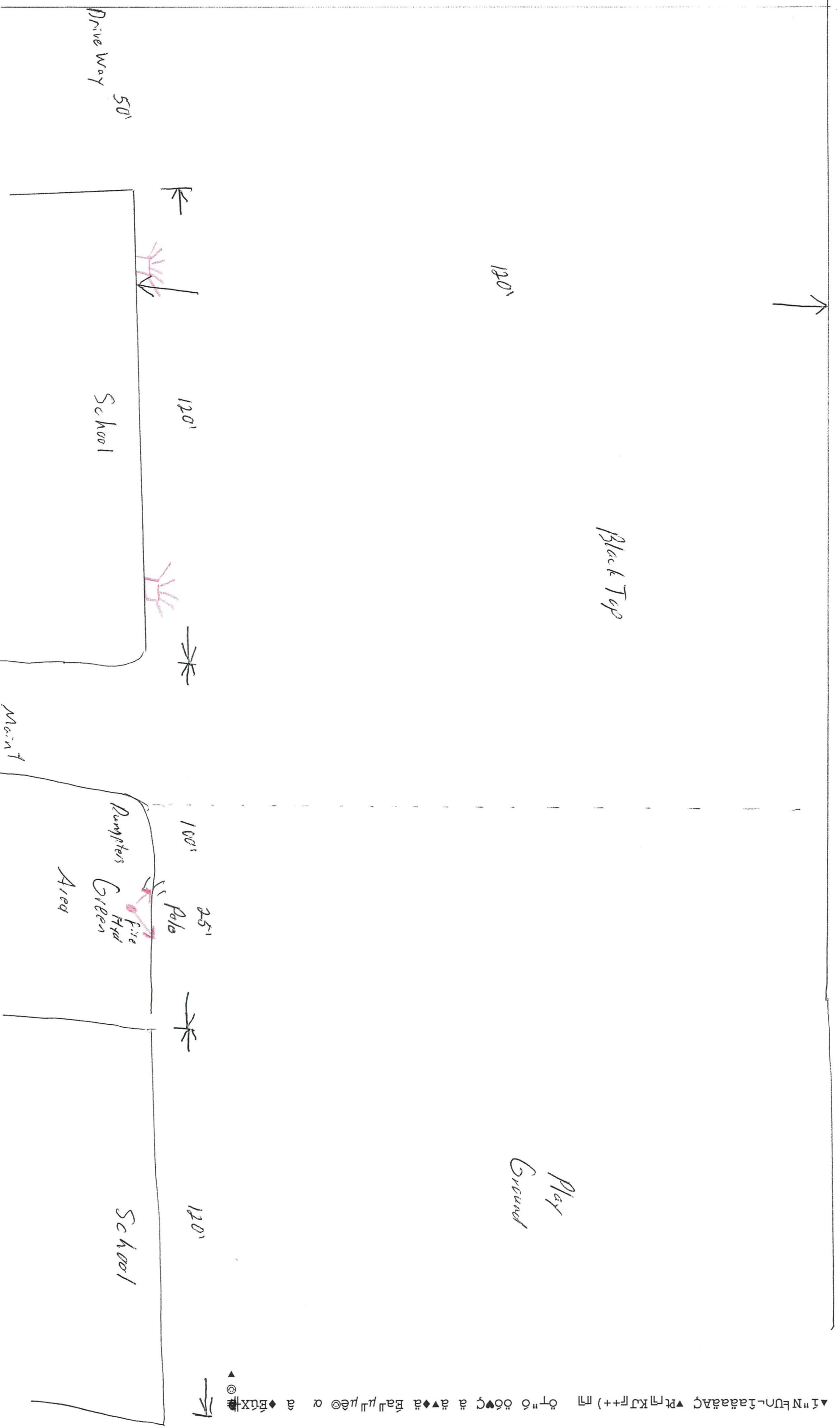

▲ 1" = 10' N E U N - f a a a a a C ▼ P r T J K J f + + ) T J Ö T " ö ö o o C ä ä ▼ ä ä F a l l μ l l e e o a ä E U X

BUILDING AND GROUNDS MONTHLY REPORT					
Account	Description	2021-22	2021-22	2021-22	FEB 2021-22
		Original Budget	FY Activity	FY %	Monthly Activity
10 E 101 324 253000 000	Repairs/Maintenance for operations	\$ 4,000.00	\$ -		
10 E 101 324 254200 000	Repairs to MES grounds/sites	\$ -	\$ 400.00	0.0%	\$ -
10 E 101 324 254300 000	Repairs to MES building	\$ 20,000.00	\$ 21,083.77	105.4%	\$ 4,042.28
10 E 101 324 254490 000	Repairs for non-instructional equipment	\$ -	\$ 823.59	#DIV/0!	\$ 416.79
10 E 101 327 255000 000	Construction (playground equipment)	\$ 6,200.00	\$ 6,370.00		
10 E 101 329 253000 000	Service for MES operations (lawncare, monitoring, rugs)	\$ 2,000.00	\$ 2,474.42	123.7%	\$ 159.74
10 E 101 331 253000 000	MES gas for heat	\$ 33,000.00	\$ 23,706.78	71.8%	\$ 6,265.49
10 E 101 336 253000 000	MES electricity	\$ 65,000.00	\$ 37,370.08	57.5%	\$ 4,135.39
10 E 101 337 253000 000	MES water	\$ 2,000.00	\$ 1,213.93	60.7%	\$ -
10 E 101 338 253000 000	MES sewer	\$ 2,000.00	\$ 1,443.62	72.2%	\$ -
10 E 101 3-- -----	*PURCHASED SERVICES	\$ 134,200.00	\$ 94,886.19	70.7%	\$ 15,019.69
10 E 101 411 253000 000	Custodial supplies for MES	\$ 14,536.00	\$ 12,678.89	87.2%	\$ 5,967.52
10 E 101 440 253000 000	Durable supplies for MES operations	\$ 1,500.00	\$ 22.19	1.5%	\$ -
10 E 101 4-- -----	*NON-CAPITAL OBJECTS	\$ 16,036.00	\$ 12,701.08	79.2%	\$ 5,967.52
10 E 101 550 253000 000	Capital Equipment, new	\$ 464.00	\$ 464.00	100.0%	\$ 464.00
10 E 101 5-- -----	*CAPITAL OBJECTS	\$ 464.00	\$ 464.00	100.0%	\$ 464.00
10 E 101 --- -----	*ELEMENTARY SCHOOL	\$ 150,700.00	\$ 108,051.27	71.7%	\$ 21,451.21
10 E 200 310 253000 000	Personal Services for operations	\$ -		#DIV/0!	
10 E 200 324 254200 000	Repairs to MMS grounds/sites	\$ -	\$ 163.40	#DIV/0!	
10 E 200 324 254300 000	Repairs to MMS building	\$ 15,000.00	\$ 16,593.65	110.6%	\$ 921.67
10 E 200 324 254490 000	Repairs for non-instructional equipment	\$ -	\$ 986.32	#DIV/0!	\$ -
10 E 200 329 253000 000	Service for MMS operations (lawncare, monitoring, rugs)	\$ 3,000.00	\$ 1,805.49	60.2%	\$ 96.51
10 E 200 331 253000 000	MMS gas for heat	\$ 12,900.00	\$ 15,769.82	122.2%	\$ 4,252.03
10 E 200 336 253000 000	MMS electricity	\$ 40,000.00	\$ 27,079.27	67.7%	\$ 161.45
10 E 200 337 253000 000	MMS water	\$ 2,150.00	\$ 715.28	33.3%	\$ -
10 E 200 338 253000 000	MMS sewer	\$ 1,290.00	\$ 899.69	69.7%	\$ -
10 E 200 3-- -----	*PURCHASED SERVICES	\$ 74,340.00	\$ 64,012.92	86.1%	\$ 5,431.66
10 E 200 411 253000 000	Custodial supplies for MMS	\$ 7,582.00	\$ 4,047.03	53.4%	\$ 1,518.73
10 E 200 440 253000 000	Durable supplies for MMS operations	\$ 911.00	\$ 806.59	88.5%	\$ 403.76
10 E 200 4-- -----	*NON-CAPITAL OBJECTS	\$ 8,493.00	\$ 4,853.62	57.1%	\$ 1,922.49
10 E 200 550 254300 000	Capital Equipment for building maintenance	\$ -	\$ 2,365.00		\$ -
10 E 200 550 253000 000	Capital Equipment for operations	\$ 1,000.00	\$ -	0.0%	\$ -
10 E 200 5-- -----	*CAPITAL OBJECTS	\$ 1,000.00	\$ 2,365.00	236.5%	\$ -
10 E 200 --- -----	*MIDDLE SCHOOL	\$ 83,833.00	\$ 71,231.54	85.0%	\$ 7,354.15
10 E 400 310 253000 000	Purchased services for operations	\$ 1,070.00	\$ -	0.0%	\$ -
10 E 400 324 254200 000	Repairs to HS grounds/sites	\$ -	\$ 216.60	#DIV/0!	\$ -
10 E 400 324 254300 000	Repairs to HS building	\$ 25,000.00	\$ 21,935.91	87.7%	\$ 1,221.73
10 E 400 324 254490 000	Repairs to non-instructional equipment	\$ -	\$ 1,307.45	0.0%	\$ -
10 E 400 329 253000 000	Services for HS operations (lawncare, monitoring, rugs)	\$ 5,700.00	\$ 2,393.33	42.0%	\$ 127.95
10 E 400 331 253000 000	HS gas for heat	\$ 17,100.00	\$ 20,904.19	122.2%	\$ 5,636.42
10 E 400 336 253000 000	HS electricity	\$ 60,000.00	\$ 43,316.85	72.2%	\$ 214.02
10 E 400 337 253000 000	HS water	\$ 1,200.00	\$ 948.14	79.0%	\$ -
10 E 400 338 253000 000	HS sewer	\$ 1,710.00	\$ 1,192.61	69.7%	\$ -
10 E 400 3-- -----	*PURCHASED SERVICES	\$ 111,780.00	\$ 92,215.08	82.5%	\$ 7,200.12
10 E 400 411 253000 000	Custodial supplies for HS	\$ 12,040.00	\$ 6,104.11	50.7%	\$ 2,013.18
10 E 400 440 253000 000	Durable supplies for HS operations	\$ 2,200.00	\$ 1,911.19	86.9%	\$ 1,322.72
10 E 400 4-- -----	*NON-CAPITAL OBJECTS	\$ 14,240.00	\$ 8,015.30	56.3%	\$ 3,335.90
10 E 400 550 254300 000	Capital Equipment for maintenance, new	\$ -	\$ 3,135.00	#DIV/0!	\$ -
10 E 400 550 253000 000	Capital Equipment for operations, new	\$ 1,000.00	\$ -	0%	\$ -
10 E 400 5-- -----	*CAPITAL OBJECTS	\$ 1,000.00	\$ 3,135.00	314%	\$ -
10 E 400 --- -----	*HIGH SCHOOL	\$ 127,020.00	\$ 103,365.38	81.4%	\$ 10,536.02
10 E 800 310 253000 000	Personal Services for operations	\$ 1,000.00	\$ 30.00	3.0%	\$ -
10 E 800 310 254200 000	Personal Services - site repairs	\$ -	\$ 727.50	#DIV/0!	\$ -
10 E 800 310 254300 000	Personal Services - building repairs	\$ 7,560.00	\$ 15,120.00	200.0%	\$ -
10 E 800 324 254200 000	Site Repairs	\$ 10,000.00	\$ 19,779.79	197.8%	\$ -
10 E 800 324 254300 000	Building Repairs	\$ 10,000.00	\$ 4,500.00	45.0%	\$ -
10 E 800 324 254490 000	Other Equipment Repairs	\$ 5,000.00	\$ 1,012.56	0.0%	\$ -
10 E 800 324 254500 000	Repairs to Kubota, truck, large van	\$ 4,000.00	\$ 3,959.96	99.0%	\$ 203.50
10 E 800 325 254200 000	Rental - equipment for site repairs	\$ -	\$ 35.00	#DIV/0!	\$ -
10 E 800 327 255000 000	Construction	\$ -	\$ 80,712.89	#DIV/0!	\$ -
10 E 800 328 255000 000	Rental - Lindsay Park	\$ 3,000.00	\$ -	0.0%	\$ -
10 E 800 329 253000 000	Garbage/Recycle service, Empty lot lawn service	\$ 13,000.00	\$ 17,314.66	133.2%	\$ 810.00
10 E 800 329 253200 000	Snow Removal Service	\$ 45,000.00	\$ 20,296.15	45.1%	\$ 6,106.50
10 E 800 337 253000 000	Water	\$ 100.00	\$ -	0.0%	\$ -
10 E 800 338 253000 000	Old ES sewer	\$ 100.00	\$ -	0.0%	\$ -
10 E 800 348 254500 000	Fuel for Kubota, truck, vans	\$ 2,000.00	\$ 1,517.97	75.9%	\$ 104.27
10 E 800 3-- -----	*PURCHASED SERVICES	\$ 100,760.00	\$ 165,006.48	163.8%	\$ 7,224.27
10 E 800 411 253000 000	General Supplies for operations	\$ -	\$ 3.99		\$ -
10 E 800 411 253200 000	Salt for snow removal company	\$ 15,000.00	\$ 8,250.00	55.0%	\$ -
10 E 800 440 254300 000	General Supplies - building repairs	\$ -	\$ 270.80	#DIV/0!	\$ -
10 E 800 440 253000 000	Durable supplies for operations - district	\$ 5,000.00	\$ 16.00	0.3%	\$ -
10 E 800 4-- -----	*NON-CAPITAL OBJECTS	\$ 20,000.00	\$ 8,540.79	42.7%	\$ -
10 E 800 --- -----	*DISTRICT WIDE	\$ 120,760.00	\$ 173,547.27	143.7%	\$ 7,224.27
		2021-22	2021-22	2021-22	FEB 2021-22
		Original Budget	FY Activity	FY %	Monthly Activity
10 E 101 --- -----	*ELEMENTARY SCHOOL	\$ 150,700.00	\$ 108,051.27	72%	\$ 21,451.21
10 E 200 --- -----	*MIDDLE SCHOOL	\$ 83,833.00	\$ 71,231.54	85%	\$ 7,354.15
10 E 400 --- -----	*JR./SR. HIGH SCHOOLS	\$ 127,020.00	\$ 103,365.38	81%	\$ 10,536.02
10 E 800 --- -----	*DISTRICT WIDE	\$ 120,760.00	\$ 173,547.27	144%	\$ 7,224.27
	<b>TOTALS</b>	\$ 482,313.00	\$ 456,195.46	95%	\$ 46,565.65